

RESTORATION OF CHANG CHIN MA **ZURMANG MONASTERY**



Drukpa Rinpoche was elected by the Zurmang Monastery, lamas, residents of the region and the local government to head this re-building project.

The biography of Venerable Zurmang Drukpa Rinpoche

The Venerable Drukpa Rinpoche is an accomplished practitioner with ever better trait in his every incarnaton, proficient in sutras, tantras and various sects' teachings of Tibetan buddhism. He is being recognized as an emanation of Chenrezig and the Venerable Angaja of teh 16 Arhats (Buddha's time). The lineage continued till the 11th incarnation.



The present Rinpoche manifests infinite compassion since young age. At age of 13, he studied under Karma Tseten Rinpoche (who accomplished in a single lifetime at a holy place - Trachuk). Under his teaching for 7 years, Drukpa Rinpoche has had received many sutra and tantric teachings like Paramartha, Guide to the Boddhistva way of life, Madyamika, Profound secret meaning and so on.

Under the guru's guidance, he diligently practiced the common and uncommon teachings and highest secret teachings like Six Yoga of Naropa, Mahamudra, Dzogchen, Trekcho and Thogal. Drukpa Rinpoche is now the realise master through diligent practice.

His Eminence 12th Tai Situpa Rinpoche recognized him as the reincarnation of Zurmang Drukpa Rinpoche and was enthroned at West Kang. Thereafter, Rinpoche received the full teachings of Zurmang Kagyu lineage from Zurmang Dyen'gha Rinpoche, rebuilt the Zurmang Ear Transmission Retreat Centre and led 10 over lamas on a 3 year and 3 months retreat. After the retreat, he sought more teachings at Trachuk for 1 year. As a realised master in all his practices, Rinpoche is the retreat master of the retreat centre at the Zurmang Monastery and conducts the monastery annual grand pujas and ceremonies.

The history of Zurmang Main Assembly Hall Chang Ching Ma

Tilopa transmitted all his precious teachings to Naropa and at the same time, promised that after thirteen lifetimes, he would appear again as the incomparable Trung Mase. He would retrieve all his teachings and again spread the dharma for the benefit of all sentient beings.

During the time of the Fifth Karmapa, Deshing Shegpa, Tilopa was re-born as Trung Mase in the district of West Kham called Minyak. When Trung Mase approached the Fifth Karmapa for blessings, the Karmapa recalled Tilopa's prediction and confirmed that Trung Mase was in fact the re-incarnation of the great Pandita, Tilopa. On the other hand, the Karmapa appeared to Trung Mase as the great bodhisattva, Avaloketishvara.

Although Trung Mase had already achieved a high level of attainment at that time, he requested the Karmapa to ordain him as a monk, in order to further benefit more sentient beings. His Holiness personally ordained Trung Mase and bestowed upon him the name of Lodro Rinchen Pal which means "The precious Jewel of Wisdom". Subsequently, he remained with the Karmapa and received many imitations, oral transmissions, as well as profound and precious teachings such as Six Yoga of Naropa, Tilopa's mahamudra teachings, the Kukupa's lineage teachings and the oral instructions of the Zurmang Kagyud tradition. For ten long years, Trung Mase engaged himself in strict retreat often under conditions of utmost austerity. Consequently, he emerged as the ultimate spiritually evolved student of the 5th Gyalwa Karmapa.



Later, at the command of the 5th Gyalwa Karmapa, Dubchen Mase proceeded to Kham in order to benefit the beings there. He was explicitly told to establish a monastery on a particular site at which two great rivers converge before flowing steadily downhill, where the terrain resembled a red horse that was split open. In accordance with a prediction of Dorje Norjolma, this was the precise location of Cakrasambhava's Speech Abode and is consecrated by the deity to ensure the complete success of religious practice.

Holding these instructions dear to his hear, Dubchen Mase traveled the length and breadth of Tibet in search of a corresponding site. By and by, he arrived at a beautiful valley in Yusheng and felt instinctively that this was the place foretold by his teacher.

Before the construction, Trung Mase blessed the ground with the help of his incarnate disciples. A hundred and eight columns were then laid as the foundation for the main hall.

Today, the monastery is about 700 years old. Through all these years, all grand pujas have been held in the main hall. Grand puja lasting 136 days continues to be held in this hallowed hall every year.



The importance of Zurmang Main Assembly Hall Chang Ching Ma

The Zurmang Monastery is a very important monastery in the Karma Kagyud Lineage. In Tibet, Tsurpu Monastery is the chief monastery of the Karma Kagyud Lineage, while in Szechuan Province; the most important monastery is His Eminence, Situ Rinpoche's monastery. In the Kham District, the Zurmang Monastery is the region's biggest monastery.

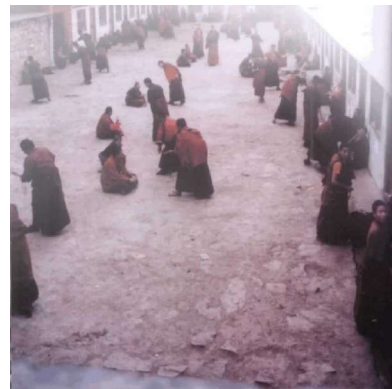

At that time, it had two thousand lamas, thirteen retreat centers and an institute of education. His Holiness, the Gyalwa Karmapa and His Eminence, Tai Situ Rinpoche also lived in this monastery for some time. Here, the teachings of the Zurmang Lineage flourished, benefiting all in this region.

The damage stage of Zurmang Main Assembly Hall Chang Ching Ma

Unfortunately, the 700 year-old monastery is now in ruins. It was repaired several times, but due to lack of proper materials, and many years of weathering, the walls are cracked, and the ceilings leak, making pujas an ordeal in the bitterly cold winter of -40°C.

The main assembly (prayer) hall was not occupied until 1994. With the kind help of disciples from many countries, the hall was renovated, although not restored to its original glory. Today, there are more than a thousand hand-made Buddha statues imported from Nepal. One of the largest images is that of Sakayamuni Buddha, a storey-high statue made of bronze.

The four walls are covered with intricate engravings and artistic murals. Floor tiles have been changed and the leaking roof repaired. Although Drukpa Rinpoche has continuously repaired the defects, the walls are now tilting dangerously, despite his efforts. All the newly completed murals are damaged by constant wall seepages. Roof beams are rotten beyond repair. Lamas now stay away from the second floor to avoid accidents. The walls are being propped up to avert the collapse of one of the main walls.



深山中的闭关所。
Mountain retreat site.



由于缺乏条件保养，
经过长期的风吹雨打，
墙壁破裂不堪。
Due to long years of
poor maintenance,
the wall has started
crumbling.



雨水从裂缝中溢出，
损坏屋顶的横梁。
Water Seeping
into the cracks
have damaged
the roof beams.





屋顶的横梁也出现裂缝。
The roof beams have also cracked.



从屋顶的顶端往下看，大殿墙壁的裂缝清晰可见
Looking down from the roof-top, you can see the cracks in the walls of the hall.



The reason why this temple badly needs to be rebuilt is because it was the main assembly hall where Zurmang Rinpoches and lamas have practiced and have so closely linked spiritually with the region. In the discussions at the monastery, Drukpa Rinpoche was elected by the Zurmang Monastery, lamas, residents of the region and the local government to head this re-building project.

The blue print of Zurmang Main Assembly Hall – Chang Ching Ma

The monastery seeks the generous help of well-wishers and donors to enable Rinpoches and lamas to continue the sacred practice of the Zurmang Lineage for the benefit of all sentient beings.

Note:

1. Donors will have their names engraved on the temple walls.
2. Rinpoche and lamas will perpetually chant prayers for all who contribute towards the building fund.

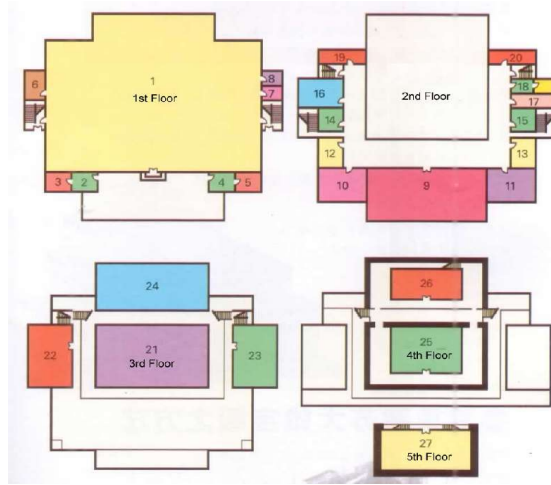

It is highly meritorious to support and contribute to the building of monasteries and temples and in order to benefit as many donors as possible, Rinpoche has kindly made the unit of contribution as small and simple as possible by equating one unit of contribution with the cost of building up a square foot of the prayer hall.

Your compassion and generosity will greatly benefit all sentient beings.

Zurmang Kagyud – Drukpa Rinpoche Building Funds

The Main Zurmang Shrine Hall in Qinghai is built on a land area of 38056 sq. feet with a total of 5 storey.

The first level will be the main puja hall where standard pujas of 136 days will be held annually. Besides this regular pujas, the daily practices, the annual world peace puja and other adhoc pujas will also be held in this hall.

The second level includes an office, precept-taking hall, retreat rooms and numerous Yidams' shrine rooms.

The third level includes secret rooms (13 secret practice), Library and the "3 year 3 month" retreat centre and different deities meditation rooms.

The fourth level includes the Kagyud lineage hall and guest rooms for visiting Rinpoches.

The fifth level is the room for Kharmapa.

We sincerely pray that all of you would participate in this meaningful project so that we will be able to spread the truth and wisdom of the Buddha far and wide. Let us join hands to sow the seeds of merit cultivation. Kindly donate to the worthy cause of the re-construction of our main shrine.

You can choose to donate in the following ways:

1. Based on per square foot, at cost of US\$28 (RB230 yuan), sponsor via individual's name the number of square foot desired.
2. Choose a specific item for sponsorship.
3. Donate any amount you wish.

Note: All whom sponsor one or more square foot, please fill up the donation form, attaching your photo and details. Zurmang Drukpa Rinpoche will bring these back to Zurmang temple, so that during all grand pujas, daily pujas and within retreat centres, merits will be dedicated to these sponsors and all sentient beings. When the restoration is complete, the names of the sponsors will be engraved on the walls of the main hall, on the door frame of rooms, or on lotus seats beneath the images. These will be left for future generations to bless, dedicate merits and receive blessings from the holy land and shrine.

If you wish to tele-transfer your donation towards the restoration of Zurmang Monastery, please tele-transfer to the following account.

Bank	: 中国银行青海省分行营业部
Account Name	: 尤加才仁
Account Number	: wxz} zzt vt t vvyvz



重建禅金玛大殿
**Re-Construction of the
 Chang Ching Ma Assembly Hall**
 苏曼竹巴仁波切 Zurmang Drukpa Rinpoche

Name 姓名	English 英	照片 Photo
	Chinese 中	
Address 地址		
Gender 性别		
Occupation 职业		
Phone 电话	Home 住家	
	Office 公司	
	Mobile 手机	
	Pager 传呼机	
Email Address 电子邮件		
US\$28 per sq. ft. 每平方尺 28 美元赞助: 请您提供您的照片。仁波切将会带回寺院，于大苏曼寺举行法会日修法， 闭关中心内日日祈愿回向功德。待大殿建成，所有功德主芳名将刻于大殿 墙壁，留于后世，以便长期祈愿回向，及获圣地大殿殊胜加持。 Please provide your photo for blessing. Rinpoche and lamas will perpetually chant prayers for all who contribute towards the building fund. Donors will have their names engraved on the temple walls.		
Signature 签名	Dharma Name 法名	Date 日期



重建禅金玛大殿
**Re-Construction of the
 Chang Ching Ma Assembly Hall**
 苏曼竹巴仁波切 Zurmang Drukpa Rinpoche

Select the item(s) you wish to sponsor 选项目赞助	Amount 数目	QTY 数量
<input type="checkbox"/> Buddha images, please indicate 佛像，请注明。	_____	_____
<input type="checkbox"/> Yidam's Shrine Room, please indicate. 本尊佛殿，请注明。	_____	_____
<input type="checkbox"/> Retreat Room, please indicate 闭关所中心，请注明。	_____	_____
<input type="checkbox"/> Others, please indicate. 其他，请注明。	_____	_____

Name 姓名	English 英	照片 Photo
	Chinese 中	
Address 地址		
Gender 性别		
Occupation 职业		
Phone 电话	Home 住家	
	Office 公司	
	Mobile 手机	
	Pager 传呼机	
Email Address 电子邮件		
Cash / Cheque No 现金/ 支票		
Total amount 总数		
Signature 签名	Dharma Name 法名	Date 日期
For Official Use 公用:		
Ref. No. 记录号码	Authorized Signature 特许签名	

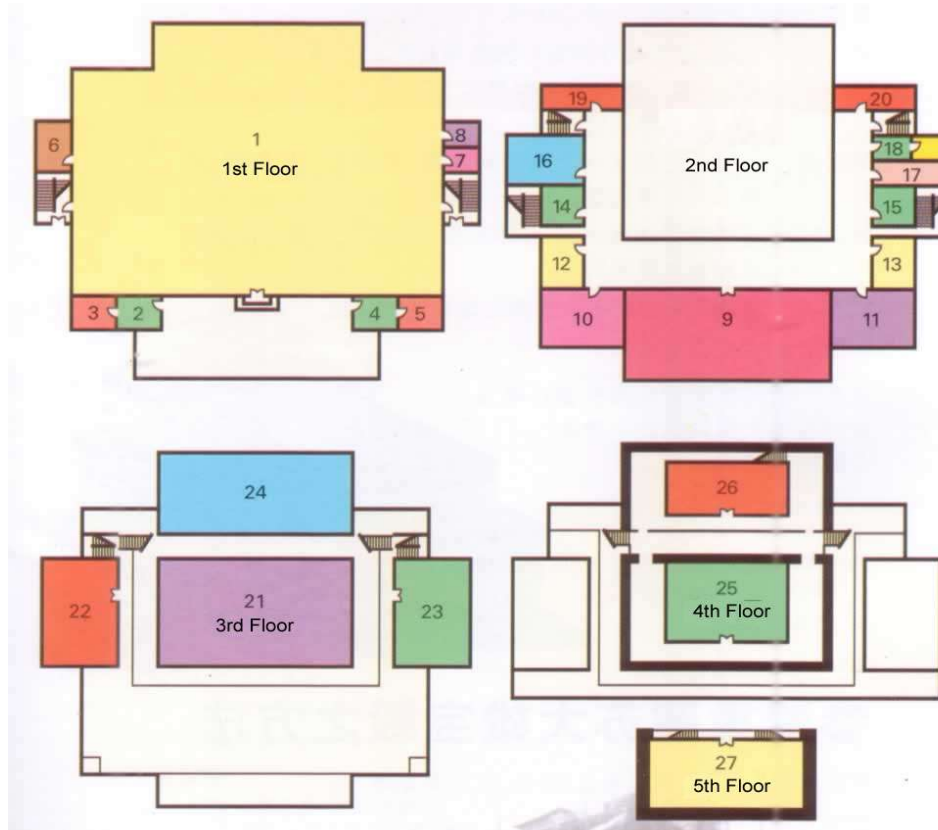

S/N	Description	Amount US\$
1st Level		
1	Main Hall (with wall paintings) Main Images (with consecration) 12m Buddha Shakyakuni image 10m Buddha Marmezed image 10m Maitreya Buddha image 5m Vajrasattva image 5m Guru Padmasambhava image 2m Manjushri image 2m Ksitigarbha image 2m Cherenzig image 2m Vajrapani image 2m Samantabhadra image 2m Akagarbha image 2m Maitreya image 2m Sarvanivaranaviskambhin image Kharmapa Throne	443,259
2	Office	8,432
3	Caretaker office/room	8,432
4	Consultation room	8,432
5	Rinpoche's guest room	8,432
6	Torma / shrine room	130,333

	7 Puja accessories	6,516
	8 Lama dance and accessories	6,516
2nd Level		
	9 Precept hall (with wall painting)	103,755
	Main images (with consecration)	
	3.5m Buddha Shakyamuni image	7,000
	2m	1,000
	2m Shariputra image	1,000
	0.6m sixteen Arhats image	10,800 (600ea)
	10 Tara Hall (with wall painting)	29,133
	Main images (with consecration)	
	1.5m Tara image	3,000
	0.6m 21 Tara image	21,000 (1000ea)
	11 Vajrasattva Hall (with wall painting)	29,133
	Main images (with consecration)	
	1.5m Vajrasattva image	3,000
	0.8m	
	0.8m	
	12 Vajrakilikilaya Hall (with wall painting)	13,033
	Main images (with consecration)	
	2m Vajrakilaya image	4,000
	0.8m Four retinue of Vajrakilaya image	1,100
	13 Amitayu Hall (with wall painting)	13,033
	Main images (with consecration)	
	1.5m Amitayu image	3,000
	1.5m Namjamma image	3,000
	1.5m White Tara image	3,000
	14 Cherenzig Hall (with wall painting)	
	Main images (with consecration)	
	1.5m Cherenzig image	3,000
	0.8m Amitabha image	1,000
	0.8m 2-arms red Cherenzig image	1,000
	0.8m Cherenzig Khasapani image	1,000
	15 Medicine Buddha hall (with wall paintings)	10,733
	Main images (with consecration)	
	2m Medicine Buddha image	3,000
	0.8m Eight Medicine buddha image	8,000 (1000ea)
	16 Guru Padmasambhava Hall (with wall painting)	
	Main Images (with consecration)	
	2m Guru Padmasambhava image	3,000
	0.8m Trisong Dhezin image	
	0.8m Khenpo Boudhi Satu image	
	0.8m Guru Rinpoche's eight manifestation image	8,000 (1000ea)
	Four foundation / other practice retreat room	
	17 (with wall painting)	13,800
	1.5m Vajrahara image	3,000
	18 Rinpoche/guest room	13,800
	Wrathful Guru Rinpoche, Sendunma retreat	
	19 room (with wall painting)	13,800

	1m Wrathful Guru Rinpoche image	1,500
	1m Sendunma image	1,500
20	Mahakala retreat center (with wall painting)	13,800
	Main Images (with consecration)	
	1m Four-arm Mahakala image	1,500
	0.8 Two-arm Mahakala image	1,500
	0.8m Svayambhurajini image	1,500
3rd Level		
21	Secret practice room (with wall painting)	118,782
	Main mandala & images (with consecration)	
	Chakrasamvara mandala	15,000
	Kalachakra mandala	15,000
	Vajravarahi mandala	15,000
	3m Chakrasamvara image	6,000
	2m Kalachakra image	6,000
	2m Cherenzig Gyalwaggyatso image	6,000
	2m Guhyasamaja image	6,000
	Mahamudra Zurmang whispering lineage retreat	
22	center (with wall painting)	50,600
	Main Images (with consecration)	
	2.5m Vajrahara image	3,000
	1.5m Chakrasamvara image	2,000
	1.5m Vajravarahi image	2,000
23	Six retreat room (with wall paintings)	
	Mahamudra retreat room	8,433
	Tara retreat room	8,433
	Vajravarahi retreat room	8,433
	Amitayu retreat room	8,433
	Wrathful Guru Rinpoche retreat room	8,433
	Dewachen retreat room	8,433
24	Library (with wall painting)	54,688
	Main Images (with consecration)	
	2m Manjushri image	3,000
	1m Manjushri image	1,300
	1m Lhamoyangchinma image	1,300
4th Level		
25	Visiting Rinpoche guest room (with wall painting)	29,133
26	Kagyud Lineage Hall (with wall painting)	68,680
	Main images (with consecration)	
	1.5 Vajrahara image	3,000
	0.6m Kagyud lineage image - 43 images	21,500 (500ea)
	0.6m Zurmang lineage holders image - 27 images	13,500 (500ea)
5th Level		
27	Kharmapa Room (with wall painting)	29,133
	Main images (with consecration)	
	3m Thousand-arm Avalokiteshvara	5,000

28 Big golden roof	74,074
29 Small golden roof	49,382

Total	1,761,442
--------------	------------------